

ECOL MOTOR
MODEL D1S 315M-4
TECHNICAL DATA SHEET

General Data	
Frame size	315
Housing material	Casting iron
Install model	According to the standard
Type of feet	Fixed feet
Net weight	1005 kg
Insulation class	F (Standard)
	H (Optional)
Protection degree	IP 55 (Standard)
	IP 56 (Optional)
Thermal protection	Without (Standard)
	Customizable (Optional)
Service duty	S1
Vibration level	A
Balance	Half-key balanced
Cable glands	2 - M63× 1.5
Cooling	IC 411
Painting color	RAL 7024 (Standard)
	Customizable (Optional)
Regulations	IEC / DIN / ISO / VDE / EN
Standard	IEC 60034

Electrical Data		
Output	132	kW
Frequency	50	Hz
Voltage (±5%)	400	V Δ @ 50Hz
	690	V Y @ 50Hz
	480	V Δ @ 60Hz
	828	V Y @ 60Hz
Rotation speed	1480	RPM @ 50Hz
	1776	RPM @ 60Hz
Rated current	226.41	A (In) @ Δ 50Hz
	130.72	A (In) @ Y 50Hz
Starting current	7	×In
Rated torque	851.76	Nm (Mn)
Starting torque	2	×Mn
Breakdown torque	2.3	×Mn
		IE1
Efficiency	93.5	@ 100% load
	94	@ 75% load
	93.6	@ 50% load
Power factor cosφ	0.9	@ 100% load

Environmental conditions	
Ambient temperature	From -20°C to +40°C
Maximum altitude	1000 m above sea level

Mechanical Data		
Bearings brand	C&U	(Standard)
	Customizable	(Optional)
Bearings type	NU319 C3	(DE)
	6319 C3	(NDE)
Lifetime of bearings		- hours
Allowed radial load		10350 N
Allowed axial load		79300 N
Grease type	polyurea-based grease	
Lubrication interval of NDE bearing		3800 h
Lubrication interval of DE bearing		7600 h
Moment of inertia	3.295790	Kg*m ²
Noise level	93	dB(A)

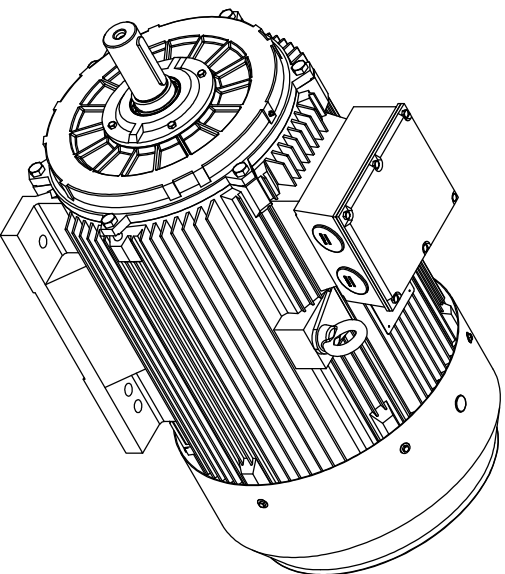
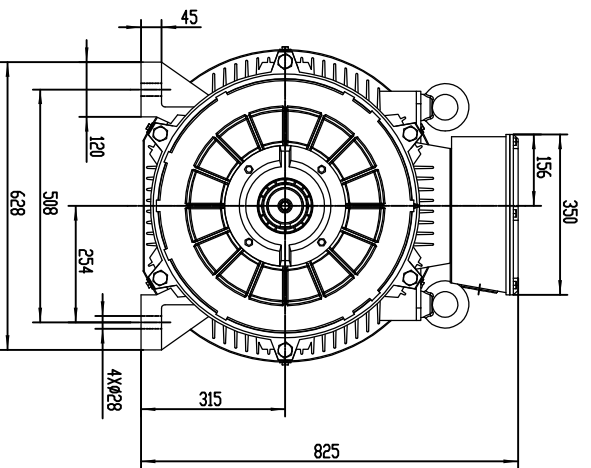
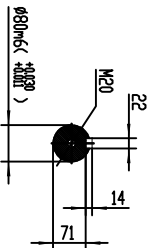
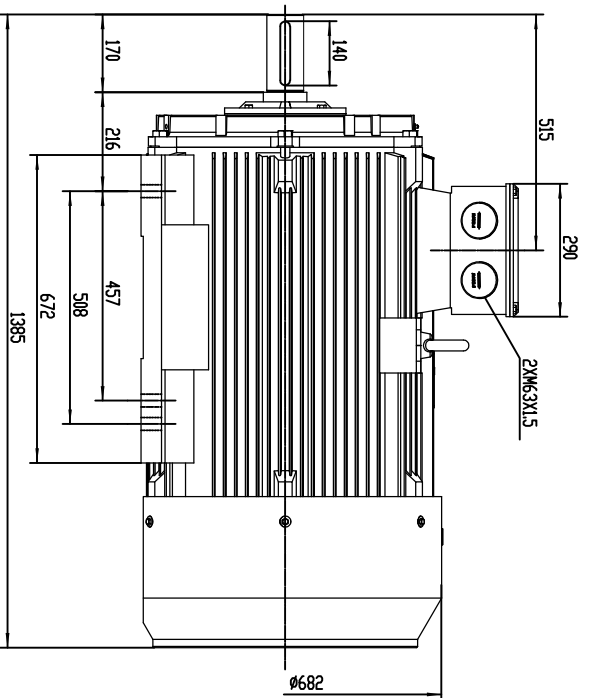

DESSUN MOTOR DIS SERIES												DS 315M/L-4,6,8P	B3 MOUNT
1HMV.010.1115B												RATE	
1:8													